



SVK

**SVK fibre cement
façade panel range**

Decorative façade panels

CONTENTS

- 04** SVK façade panels
- 08** Ornimat
- 14** Decoboard
- 16** Puro Plus
- 18** Colormat
- 20** Installation
- 22** Façade panel range

Dison (BE): Ornimat, colour 63 - Greybox Architecture





SVK:

Decorative façade panels

The façade is the face of the house and determines the appearance of the building. As an architect, contractor or client, you also take the greatest care in choosing the right type of cladding, colour, fixing method and detail finishing. Need ideas? At SVK you are in the right place! Our wide range of decorative façade panels in fibre cement gives you complete creative freedom. Carte blanche.

On the following pages, you will discover the endless possibilities for variation and combination. Regardless in which style you build, you will be sure to find the inspiration you seek.



Dison (BE): Ornimat, colour 63 - Greybox Architecture

SVK FAÇADE PANELS

Creative freedom

'Creativity up front.' The decorative fibre cement façade panels give priority to creativity. With four different types of panel, a wide range of colours and the potential for custom work, every project has an original look. Create a finish that is as individual as you.



Rotselaar (BE): Ornimat, colour 55 - Architect Céline Duyver



Ede (NL): Ornimat, colour 9010 - Architects De Jong Gortemaker Algra and Koldeweij

New construction

Is your architecture traditional or modern? Does it have large, smooth surfaces or a more complex structure? Is everything in one colour or in an original colour combination, subtle shade variation or contrasting colours? SVK offers façade panels in both classic and contemporary – but always stylish – colours. Cut to size or in standard dimensions. Through-coloured or not. You will find enough inspiration here to start creating. For private homes, but also for office buildings and blocks of flats, shops, and so on.



Hombeek (BE): Ornimat, colour RAL 7021 - Architect Daan Van Troyen

Renovation

Renovation projects have been on the rise for a while now. The possibilities for giving a building a complete makeover are therefore nearly endless. With SVK façade panels, you can renew the exterior in the style you want. The varied range offers you a wide variety of elegant solutions and gives the façade a refreshed and contemporary appearance.



Eppegem (BE): Ornimat, colour 135 Design - Atelier Kyoto

Ventilated façade

With the ventilated façade system, the façade panel works like an umbrella: it protects the underlying insulation and façade structure against all the vagaries of our climate. In the meantime, the ventilation between the panel and the underlying construction elements ensures that the entire construction can continue to 'breathe'. All advantages of a ventilated façade: minimum weight, maximum performance and optimal living comfort.

A type of panel for every façade

SVK has 4 types of façade panels: Ornimat, Decoboard, Puro Plus and Colormat. Each panel has its specific qualities and advantages. In this

way there is a façade panel for every application. Let our impressive collection inspire you and your project.

ORNIMAT Unlimited in colour and format, made to measure and with a coloured edge



DECOBOARD

For a contemporary and durable look - fast delivery



10-year warranty

SVK guarantees the durability of the material for a period of 10 years. In other words, SVK guarantees that all façade panels conform 100% to the demands of the European standard (EN12467) for weather resistance, dimensional tolerances,

physical qualities and durability. Furthermore, SVK also gives a 10-year warranty on the colour (only for Ornimat and Decoboard).

PURO PLUS

Follow the rhythm of nature

COLORMAT

Through-coloured and hydrophobic



At www.svk.be...

... you will always find the most up-to-date information about SVK façade panels:

- References
- Important points for storage and transport
- Technical data
- Prescriptions of the specifications



Inspired to discover more?
Then visit our website at www.svk.be.

ORNIMAT

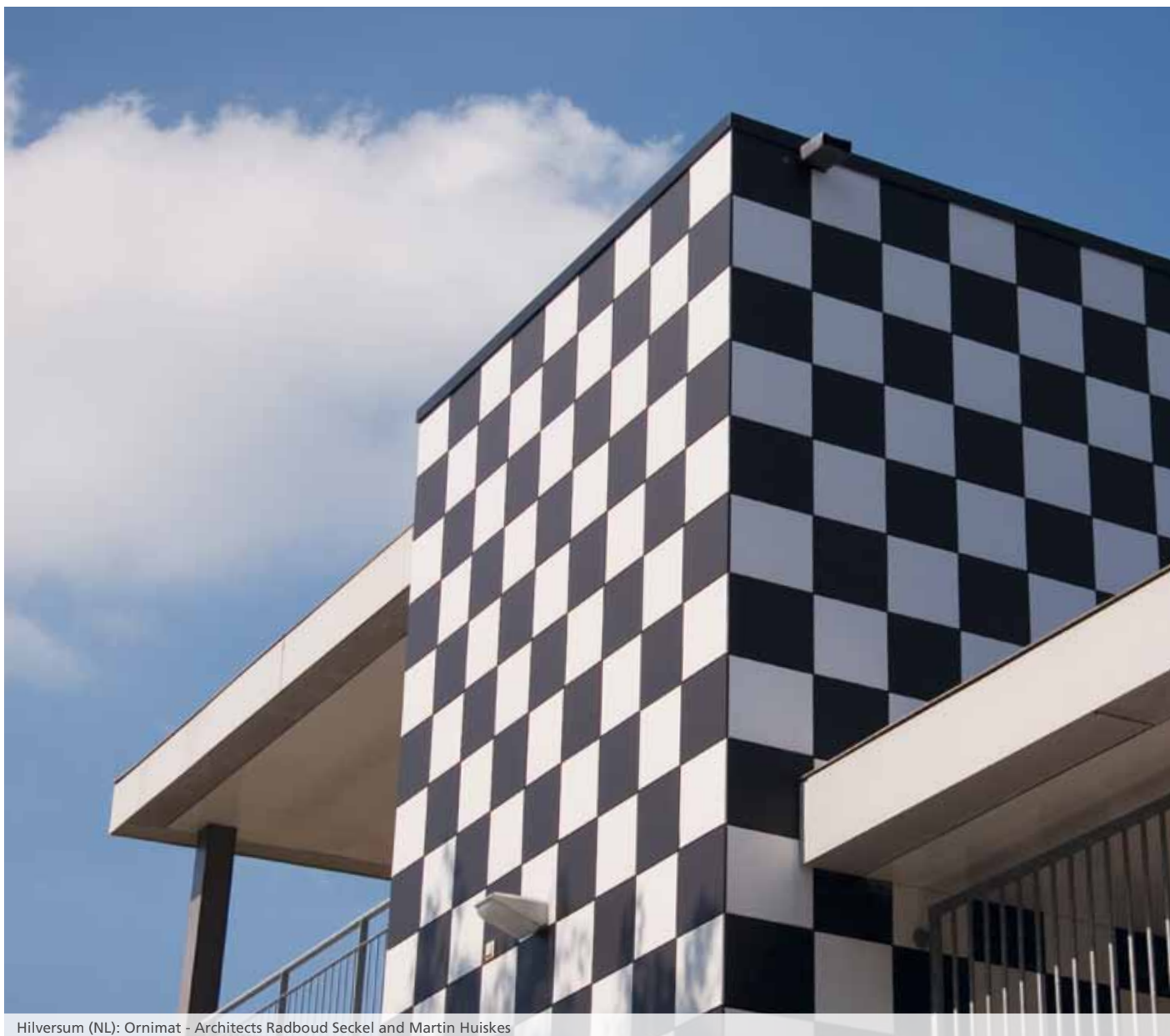

Hilversum (NL): Ornimat - Architects Radboud Seckel and Martin Huiskes

Decorative façade panel delivered to you custom sized

Aesthetics and quality combined in a timeless and durable product. That is what the Ornimat façade panels from SVK are all about. They are entirely cut

to size and offer endless creative possibilities. The broad range of shades – from traditional to contemporary – gives you full carte blanche.

The SVK logo consists of the letters 'SVK' in a bold, white, sans-serif font, centered within a solid red square.

Eppegem (BE): Ornimat, colour 135 - Atelier Kyoto



Ayeneux (BE): Ornimat, colour 69

Unique, premium quality

These façade panels are finished with a UV-resistant polyurethane paint with a matt finish (Standard) or discrete metal sparkle look (Design).

They are cut to size before being finished.

The edges of the panels are machine-coloured with the same high-quality coating as the front side. This gives them a uniform effect that is unique in the world of fibre cement façade panels!



Brasschaat (BE): Ornimat, colour 130 - SVR Architects

Complete creative freedom

Ornimat literally lets your imagination run wild! The creative possibilities of this façade panel are inexhaustible. On the one hand, nearly all colours are possible, whether in combination with one another or not (shade variation or contrasting). Furthermore, you can play with various shapes and

even include perforations. Finally, alternating fibre cement façade panels with wood, facing bricks or metal opens up even more perspectives for a unique end result. With Ornimat you get a total concept.



Hoogvliet (NL): Ornimat, colours RAL 6001, 6017, 7005, 7036 and 9002



Grimbergen (BE): Ornimat, colour RAL 7016



Nijvel (BE): Ornimat, colour 61 - Architect Van Haeren



Gent (BE): Ornimat, colours 60 and 69

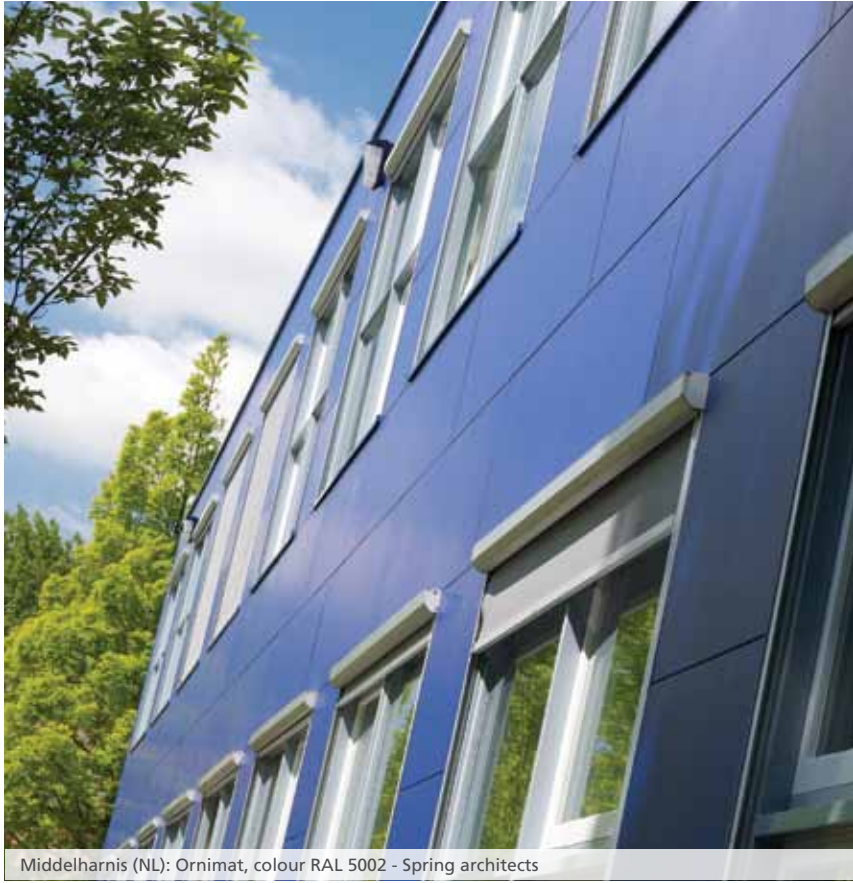

Middelharnis (NL): Ornimat, colour RAL 5002 - Spring architects

Low maintenance

Ornimat façade panels require only limited maintenance thanks to the strong protective coating. Pure water or water with an ordinary liquid detergent suffices.

The broad range of colours and cutting to size ensure inexhaustible variation and combination possibilities.

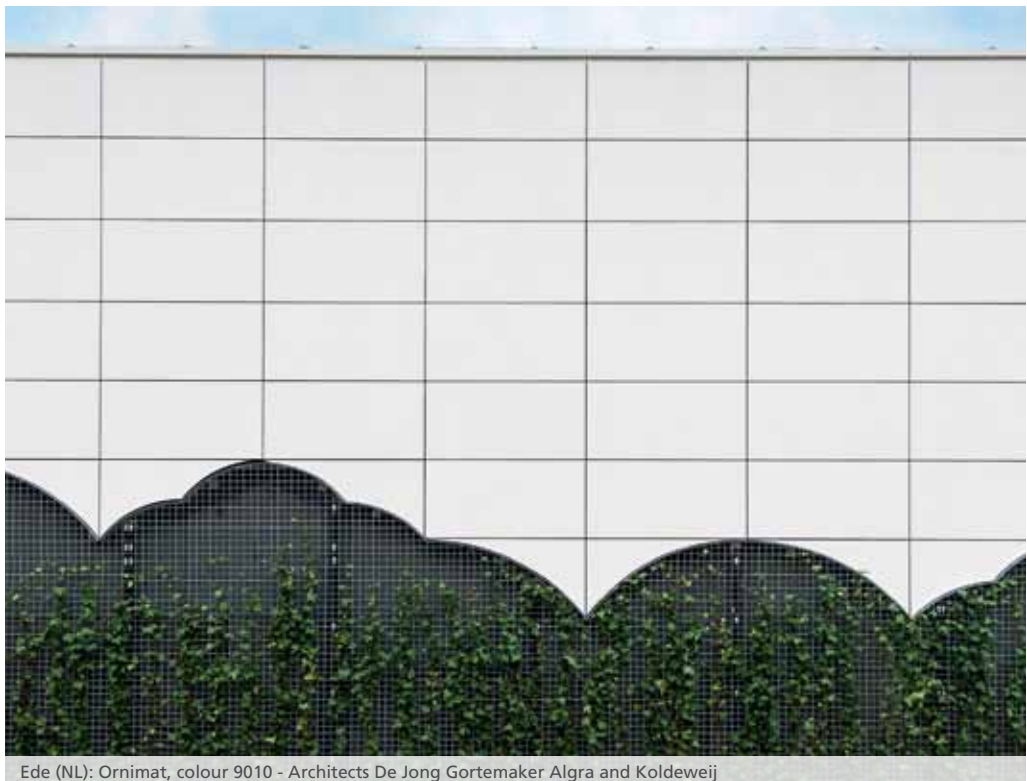

Ede (NL): Ornimat, colour 9010 - Architects De Jong Gortemaker Algra and Koldeweij

Extensive colour palette

Having 20 standard solid colours with a matt finish, Ornimat façade panels provide an answer to suit everyone's taste. Classic or stylish.

Mutually combined or not. Tone-on-tone or contrasting. The choice is yours. The 16 colours of the Ornimat design range are the crème de la crème. The subtle metal sparkle in the finishing layers gives a little more cachet touch. Have you

seen a colour somewhere that you absolutely adore? Or do you want the façade panels to match with the colours of the other materials used in the building? Choose from our 62 standard RAL colours or select the NCS or RAL colour of your choice from 50 m² onwards.



Dolhain (BE): Ornimat, colour 140 Design - Greybox



Istanbul (TU): Istanbul Technical University



Tielt (BE): Ornimat, colour 134 Design - Architect Bart Verstaen

The edges of the panel are coloured at the same time, creating a uniform whole.



Custom work

Ornimat is a complete concept. It is not a standard product, but pure customized work. The façade panels are cut according to the dimensions and specifications provided: sloping, curved, with or without pre-drilled holes. The edges are coloured at the same time as the panel so that a ready-made product leaves the factory. It can be installed

immediately without extra cutting or manual work.

We can - upon request - also deliver the cut-to-size panels at the construction site according to the wishes of the installation company in order to guarantee the quickest possible installation. Because time is money!



Elsene (BE): Ornimat, colour 56

DECOBOARD

For a stylish and durable look

Looking for a contemporary, smooth finishing for your façade? Then the SVK Decoboard façade panels are the ideal solution for new construction as well as renovation. The panels are manufactured from the very best raw materials and finished

with 3 layers of UV-resistant acrylic paint. The 4 standard coating colours available are timeless and give your façade a modern, stylish look.

From 50 m² onwards, nearly all NCS and RAL colours can be ordered.



Always in stock

The Decoboard façade panels in standard colours are always in stock and can thus be delivered quickly. Furthermore, they are available in two formats which again benefits optimization.



Decoboard façade panels finish the façade perfectly in contemporary colours.

SVK

PURO PLUS

Follow the rhythm of nature

The Puro Plus façade panel, available in two standard sizes, is through-coloured natural grey and has a lightly sanded surface that only develops patina by the action of natural elements.

Puro Plus does not have a coating. Changing weather conditions create a typical, natural play of shades of grey. Ideal for a façade with a robust but natural look.

Natural appearance

Because of the lightly sanded surface of the fibre cement, Puro Plus exudes the purity of smooth

concrete. In this way you create a lovely aesthetic effect with an apparently simple product.



Cornesse (BE): Greybox Architecture



Maaseik (BE): Architect Jef Vandekerckhof



Always in stock

Puro Plus façade panels can be delivered from stock.

**Puro Plus gives your façade
a natural, dynamic look.**



Maaseik (BE): Architect Jef Vandekerckhof

COLOORMAT



Enschede (NL): Colormat, colour H404 - BCT Architecten

Through-coloured and hydrophobic

Colormat façade panels are through-coloured and are autoclaved. They retain their base hue thanks to a transparent hydrophobic finish. The result is a water and dirt repellent panel that ages naturally.

Hence, for a subtle appearance Colormat is the right choice. Choose from 4 basic colours or from 8 project colours from 150 m² onwards.



Boom (BE): Colormat, colour H402 - Investpro

Contemporary, natural look

Colormat façade panels are lightly sanded during production. This gives a finely lined pattern on the front side. Due to the matt protective layer, the ageing process occurs naturally. And thanks to the transparent finish, the panels retain the typical look of fibre cement.



INSTALLATION

Through the years, SVK has developed a variety of methods for fixing façade panels. Each of these techniques guarantees a durable result. **Moreover, both visible and invisible fixing are possible with the same panel thickness (8 mm), and that is unique!**

Visible fixing

SCREWS

All SVK façade panels can be attached with screws to the (wood or metal) support structure. For this we use façade panel screws with a coated round head. These are placed perpendicularly in the middle of the pre-drilled screw holes. However, they must not be placed too tightly, so that some adjustment of the panels is still possible.

RIVETING

All SVK façade panels can be attached to metal support structures using rivets.

Screws and rivets are available in the same colour as the façade panel.

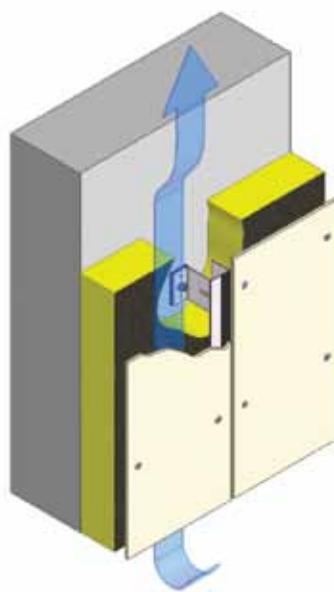
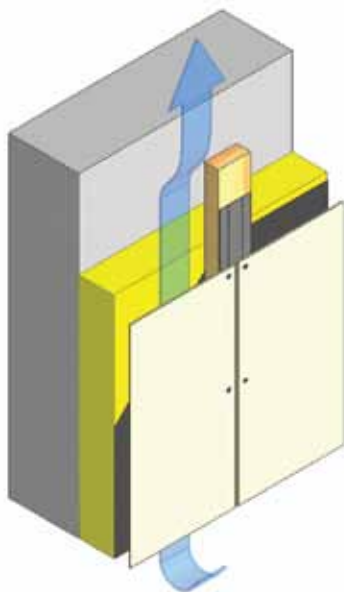

Invisible fixing

Do you prefer an extra-smooth façade finish?
Cladding without visible points of attachment? Then
opt for invisible fixing of the façade panels.

GLUING

SVK façade panels are glued with a gluing system that remains elastic and is specially designed for façade panels. This consists of a double-sided, self-adhesive strip and durable elastic glue. More information is available in the technical data at www.svk.be.

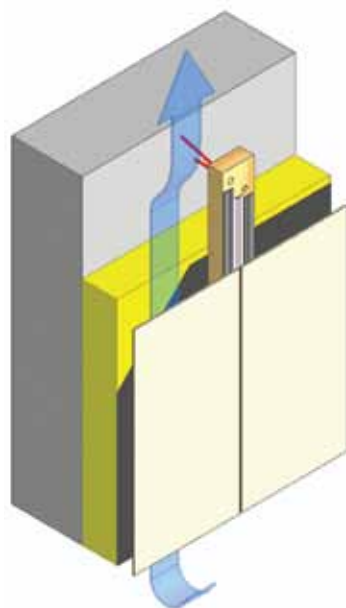





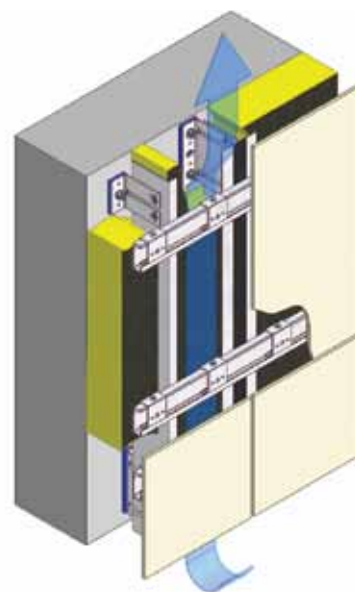









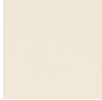
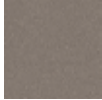
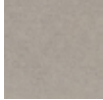

UNIQUE! MECHANICAL FIXING ON 8 MM FAÇADE PANELS

Due to the strength of our panel, you can also use
SVK **8 mm façade panels** with invisible mechanical
fixings (with Ornimat, Decoboard and Puro Plus).
Holes are drilled to size on the reverse of the façade
panels. Panel hooks or panel hook profiles are
attached with a tension-free anchor (consisting of
a sleeve and a six-sided fastener head). The façade
panels are then installed on the support structure
using these panel hooks. The result looks stylish and
exceptionally smooth.



BRAND NAME	ORNIMAT EXCLUSIVE
FINISH	<ul style="list-style-type: none"> » Two-component polyurethane paint » Cut to size » High-quality coating » Edges coated in the same colour
DIMENSIONS (mm)	
» NOT SQUARED	-
» SQUARED	≤ 3070 x 1220
THICKNESS (mm)	8
COLOURS	<div> <div>20 STANDARD COLOURS</div> <div> <div>51 beige</div><div>53 pearl grey</div><div>54 grey</div><div>55 white</div><div>56 grey blue</div><div>60 light grey</div><div>61 black</div><div>63 red</div> </div> <div> <div>68 dark grey</div><div>69 anthracite</div><div>70 pastel yellow</div><div>71 light pastel beige</div><div>75 pastel violet</div><div>77 mid pastel blue</div><div>78 pastel green</div><div>79 cloud white</div> </div> <div> <div>765 light brown</div><div>1015 ivory white</div><div>3002 carmine red</div><div>9010 eggshell white</div> </div> </div> <div> <div>16 DESIGN COLOURS</div> <div> <div>130 silver</div><div>131 tin</div><div>133 gold</div><div>134 cinnamon brown</div><div>135 copper</div><div>140 haematite</div><div>141 eggplant</div><div>142 ink blue</div> </div> <div> <div>143 serpentine green</div><div>144 ebony</div><div>151 amethyst</div><div>152 agate blue</div><div>153 aventurine green</div><div>154 bronze</div><div>160 nickel</div><div>163 pistachio green</div> </div> </div> <p>Have you seen a colour in Ornimat of Decoboard that you absolutely adore? Or do you want the façade panels to match with the colours of the other materials used in the building? From 50 m² onwards nearly everything is possible in the NCS or RAL colour of your choosing.</p>
INSTALLATION METHOD	screws / rivets / glue / invisible mechanical fixing

DECOBOARD	PURO PLUS	COLORMAT
» Acrylic paint » Short delivery time » Contemporary colours » Smooth finish	» Expressive grey tints » Natural appearance » Slightly rough finish » Short delivery time	» Hydrophobic » Expressive colours » Natural shades and patterns » Through-coloured
3085 x 1235 & 2535 x 1235	3085 x 1235 & 2535 x 1235	
3070 x 1220 & 2520 x 1220	3070 x 1220 & 2520 x 1220	3050 x 1220 & 2500 x 1220
8	8	8
<div>505 white</div>  <div>600 light grey</div>  <div>608 dark grey</div>  <div>601 black</div>  		<div>4 STANDARD COLOURS</div> <div>H401 jasmine</div>  <div>H402 slate</div>  <div>H403 storm</div>  <div>H404 charcoal</div>  <div>8 PROJECT COLOURS STARTING FROM 150 M²</div> <div>H405 natural</div>  <div>H406 camel</div>  <div>H407 daybreak</div>  <div>H408 chestnut</div>  <div>H409 sunset</div>  <div>H410 earth</div>  <div>H411 raspberry</div>  <div>H412 champagne</div> 
screws / rivets / glue / invisible mechanical fixing	screws / rivets / glue / invisible mechanical fixing	screws / rivets / glue (according to SVK advice)

Interested in SVK façade panels?

Visit our website at www.svk.be
or phone +32 3 760 49 00.



SVK nv
Aerschotstraat 114, B-9100 Sint-Niklaas
T: +32 3 760 49 00
F: +32 3 777 47 84
info@svk.be / www.svk.be



Creativity up front.

FAÇADE & ROOF